

SECTION A-A: TYPICAL ROAD CROSS SECTION

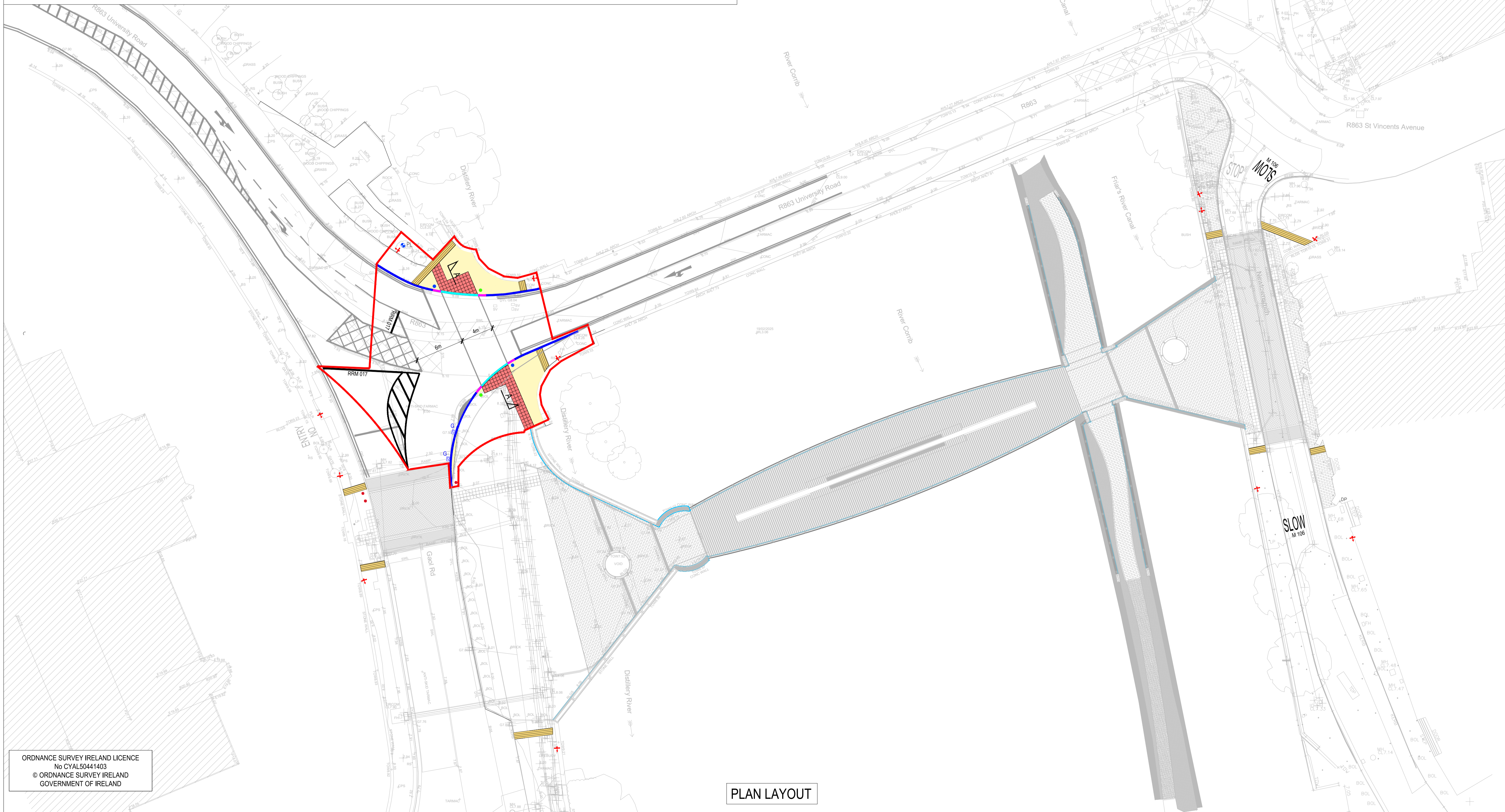

ORDNANCE SURVEY IRELAND LICENCE
No CYAL50441403
© ORDNANCE SURVEY IRELAND
GOVERNMENT OF IRELAND

PLAN LAYOUT

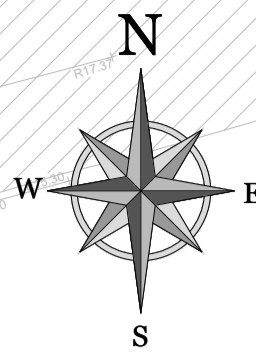
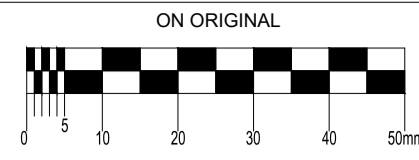

© COPYRIGHT OF THIS DRAWING IS RESERVED BY DBFL CONSULTING ENGINEERS. NO PART SHALL BE REPRODUCED OR TRANSMITTED WITHOUT THEIR WRITTEN PERMISSION.

NO CHANGES OF WHATSOEVER NATURE ARE TO BE MADE TO ANY DETAILS SET OUT OR CONTAINED IN ANY DBFL SPECIFICATIONS OR DRAWINGS UNLESS THE EXPRESS CONSENT HAS BEEN OBTAINED IN ADVANCE, IN WRITING, FROM DBFL.

NOTES:

- GENERAL NOTES:
1. ALL CO-ORDINATES ARE TO IRISH TRANSVERSE MERCATOR (BASED ON OS MAPPING)
 2. ALL LEVELS ARE TO ORDNANCE DATUM MALIN HEAD (BASED ON LIDAR SURVEY INFORMATION)
 3. ALL DIMENSIONS IN METERS UNLESS SPECIFIED OTHERWISE
 4. DO NOT SCALE FROM DRAWING

- LEGEND:
- LANDS MADE AVAILABLE
 - PROPOSED ROAD
 - SHARED PATH (NEW PAVING TO MATCH EXISTING)
 - PROPOSED RED BLISTER TACTILE PAVING
 - PROPOSED CORDUROY PAVING
 - PROPOSED CONCRETE KERB
 - PROPOSED DROPPED KERB
 - PROPOSED TRANSITION KERB
 - RELOCATED EXISTING GULLY
 - PROPOSED PUBLIC LIGHTING POLE
 - 114mm DIAMETER STAINLESS STEEL BOLLARDS TO MATCH EXISTING (TBO)
 - 4m STAINLESS STEEL TRAFFIC SIGNAL POLE (POLE TO BE CRANKED)
 - PUSH BUTTON UNIT FITTED WITH AUDIBLE SOUNDER AND TACTILE DEVICE (POLE TO BE CRANKED)

0	03-03-25	ISSUED FOR PLANNING	MS	KP
rev	date	description	by	chkd.
STATUS CODES				
purpose		acceptance		
P3 - PLANNING PERMISSION		S - ISSUED		

DBFL
CONSULTING ENGINEERS

T: +353 1 400 4000 | E: info@dbfl.ie | W: www.dbfl.ie
DUBLIN | CORK | GALWAY | WATERFORD

project ref.
SALMON WEIR PEDESTRIAN CROSSING

drawing title
**TYPICAL ROAD CROSS SECTION
SHEET 1**

client
GALWAY CITY COUNCIL

designed by	author	scale	sheet size
KP	MS	AS SHOWN	A1
drawing no.	revision		
250005-X-04-Z00-XXX-DR-DBFL-CE-5205	0		

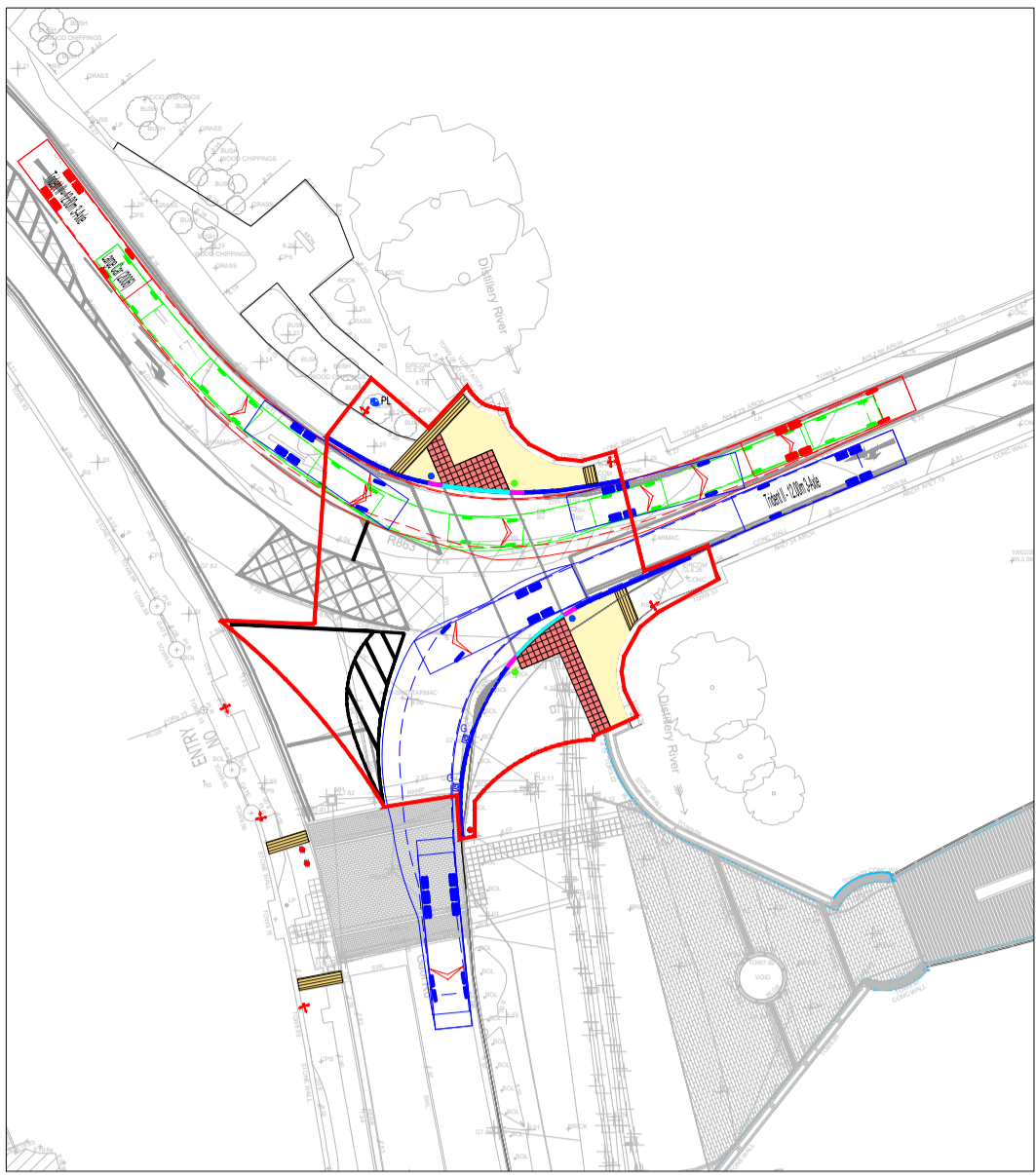

SCENARIO 1
scale 1:500

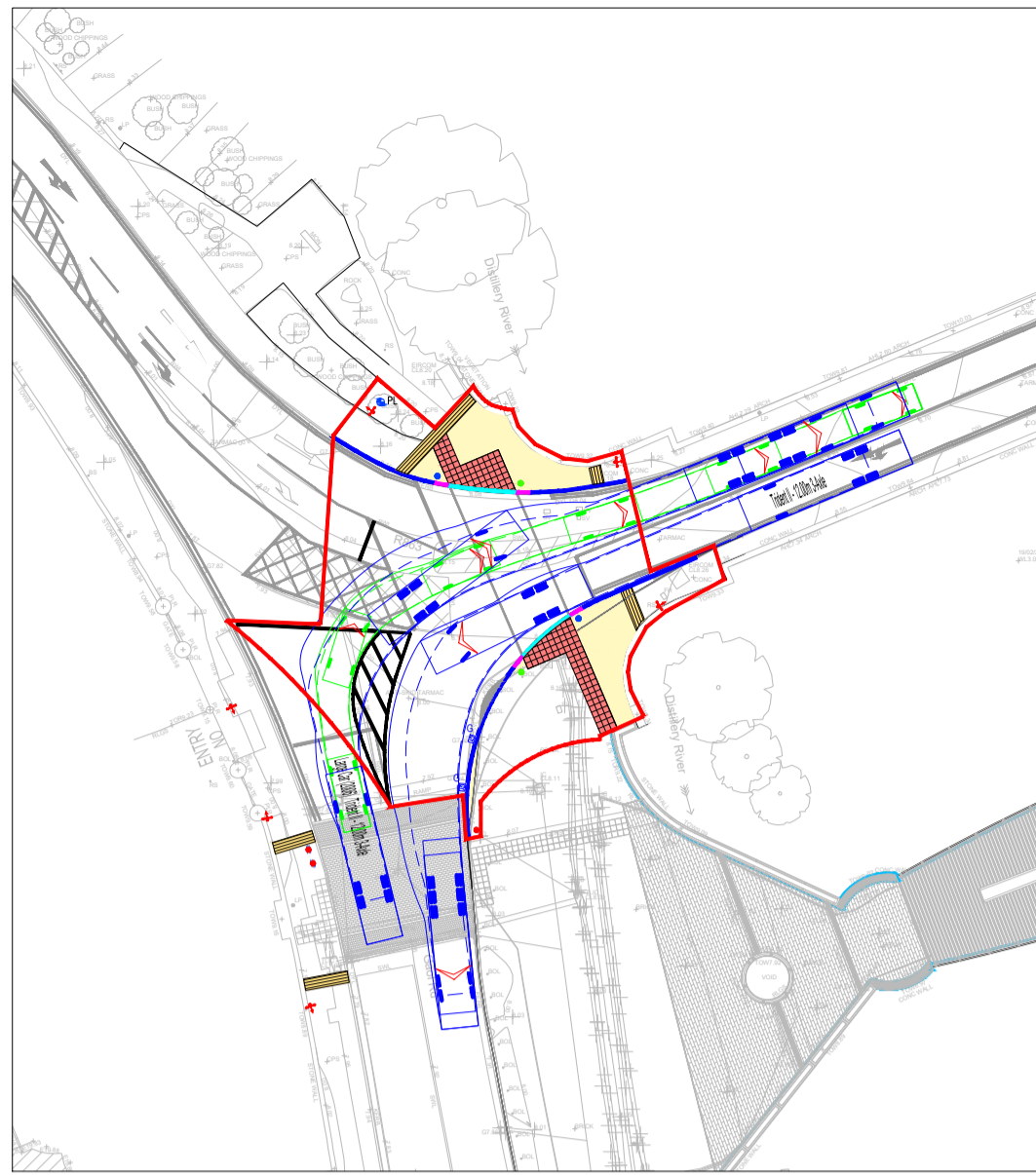

SCENARIO 2
scale 1:500

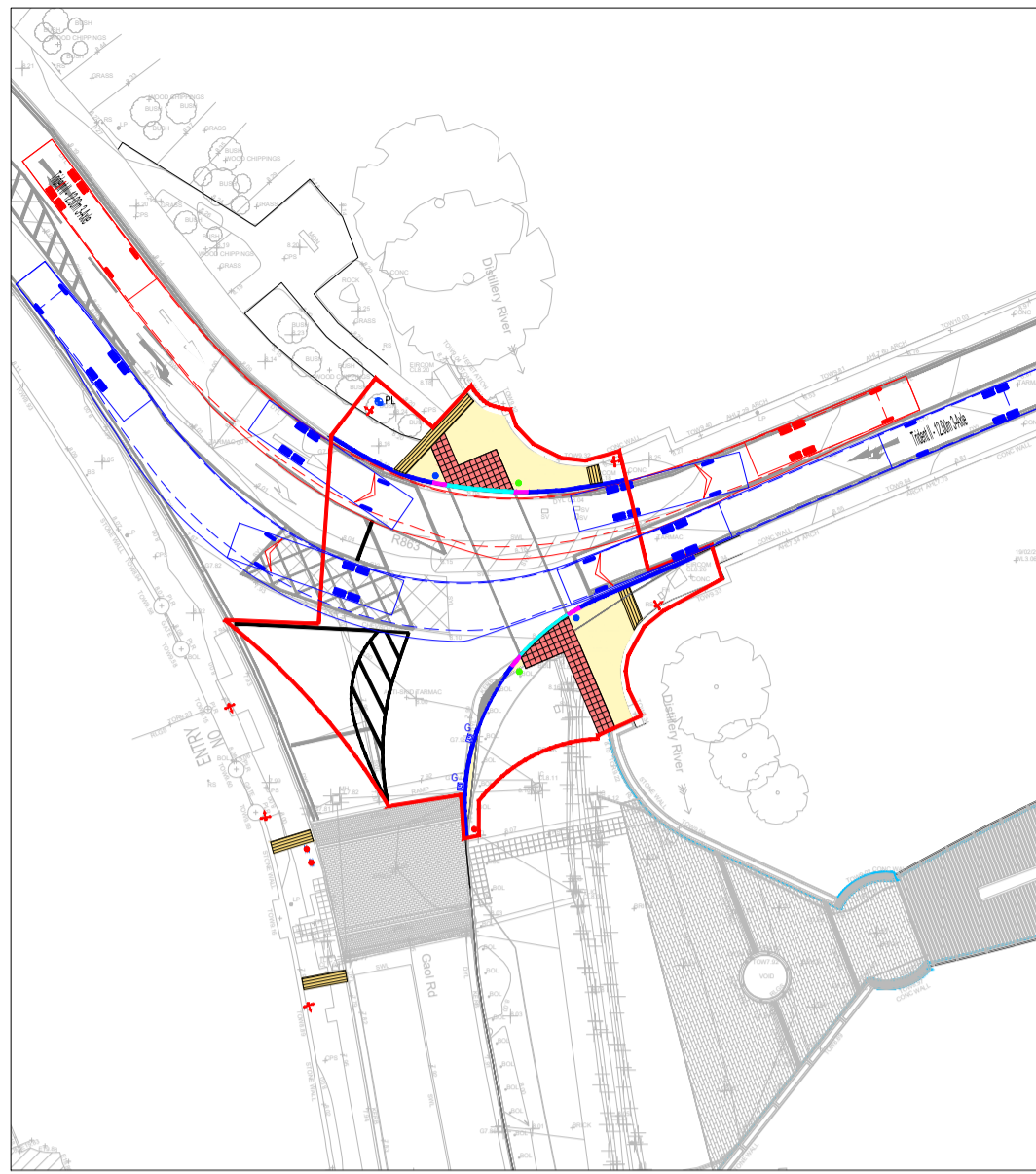

SCENARIO 3
scale 1:500

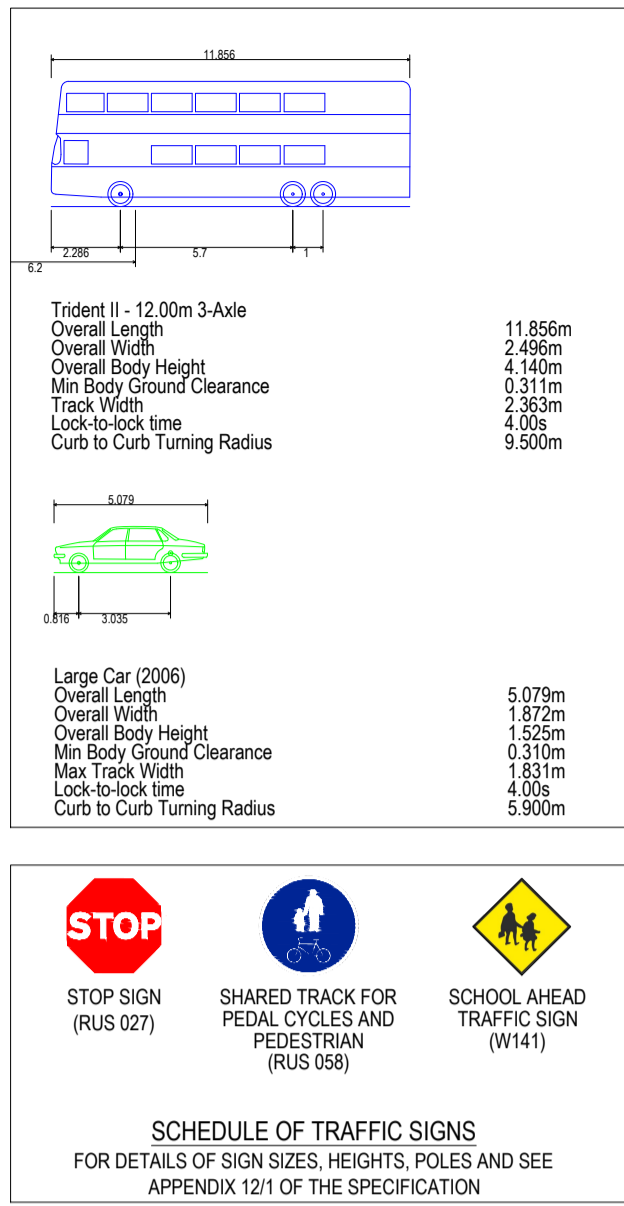

SCHEDULE OF TRAFFIC SIGNS
FOR DETAILS OF SIGN SIZES, HEIGHTS, POLES AND SEE
APPENDIX 121 OF THE SPECIFICATION

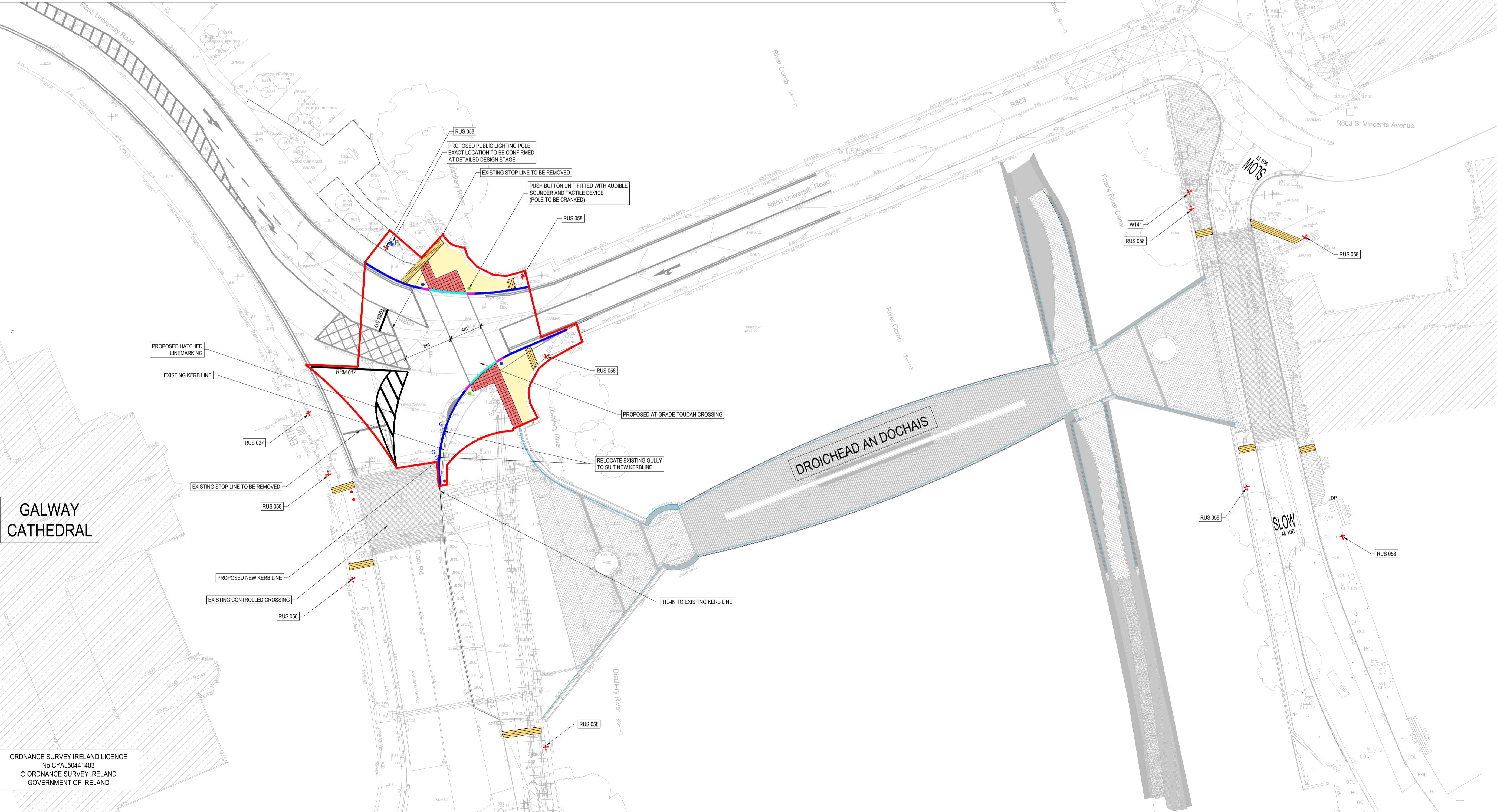

ON ORIGINAL

0 5 10 20 30 40 50mm

© COPYRIGHT OF THIS DRAWING IS RESERVED BY DBFL CONSULTING ENGINEERS. NO PART SHALL BE REPRODUCED OR TRANSMITTED WITHOUT THEIR WRITTEN PERMISSION.

NO CHANGES OF WHATSOEVER NATURE ARE TO BE MADE TO ANY DETAILS SET OUT OR CONTAINED IN ANY DBFL SPECIFICATIONS OR DRAWINGS UNLESS THE EXPRESS CONSENT HAS BEEN OBTAINED IN ADVANCE, IN WRITING, FROM DBFL.

NOTES:
GENERAL NOTES:
1. ALL CO-ORDINATES ARE TO IRISH TRANSVERSE MERCATOR (BASED ON OS MAPPING)
2. ALL LEVELS ARE TO ORDNANCE DATUM MALIN HEAD (BASED ON LIDAR SURVEY INFORMATION)
3. ALL DIMENSIONS IN METERS UNLESS SPECIFIED OTHERWISE
4. DO NOT SCALE FROM DRAWING

LEGEND:

LANDS MADE AVAILABLE

PROPOSED ROAD

SHARED PATH (NEW PAVING TO MATCH EXISTING)

PROPOSED RED BLISTER TACTILE PAVING

PROPOSED CORDUROY PAVING

PROPOSED CONCRETE KERB

PROPOSED DROPPED KERB

PROPOSED TRANSITION KERB

RELOCATED EXISTING GULLY

PROPOSED PUBLIC LIGHTING POLE

114mm DIAMETER STAINLESS STEEL BOLLARDS TO MATCH EXISTING (TBO)

4m STAINLESS STEEL TRAFFIC SIGNAL POLE (POLE TO BE CRANKED)

PUSH BUTTON UNIT FITTED WITH AUDIBLE SOUNDER AND TACTILE DEVICE (POLE TO BE CRANKED)

3	03-03-25	UPDATED TOPOGRAPHIC SURVEY	MS	KP
2	25-02-2025	ISSUED FOR PLANNING	PV	KP
1	19-02-2025	ISSUED FOR FINAL COMMENTS	PV	KP
0	30-01-2025	ISSUED FOR DESIGN TEAM DISCUSSION	PV	KP

rev	date	description	by	chkd.
STATUS CODES				
purpose		acceptance		
P3 - PLANNING PERMISSION		S - ISSUED		

DBFL

CONSULTING ENGINEERS

T: +353 1 400 4000 | E: info@dbfl.ie | W: www.dbfl.ie

DUBLIN | CORK | GALWAY | WATERFORD

project ref.

SALMON WEIR PEDESTRIAN CROSSING

drawing title

GENERAL ARRANGEMENT

client

GALWAY CITY COUNCIL

designed by	author	scale	sheet size
KP	PV	1:250	A1
drawing no.	revision		
250005-X-04-Z00-DTM-M2-DBFL-CE-1201			3